



# TISSUE CULTURE PROCEDURE

CULTURE

## STEP 4: TRANSFER

SCAN to watch our Tissue Culture Procedure Video:



### ⚠️ DISCLAIMER:

- All sterile work is to be done under the workzone unless stated otherwise.
- Always wear gloves and a face covering when working in the workzone.
- Any container with liquid placed in the Autoclave must have a loosely opened lid.
- Spray gloves with alcohol between processes in the workzone.

- 4A.** Wrap the **forceps, scalpel, work surface, and paper towel** in aluminum foil to place in the **Autoclave** for a full cycle.
- 4B.** Clean and sterilize the **Flow Hood workzone** with alcohol wipes (inside and front surfaces).
- 4C.** Use the alcohol sprayer to sterilize all **culture vessels** filled with **Roots/ Shoots** formula, the vessels with explants, and the **alcohol burner** before placing them into the **workzone**.
- 4D.** Place the items from the **Autoclave** directly under the **Flow Hood**.
- 4E.** Remove an explant showing prominent new growth from the **Shoots culture vessels** and place it on the **work surface**.  
**Note:** Ensure that the tools do not touch the media or **culture vessels**.

- 4F.** Dissect the explant at the middle of each internode leaving enough stem under each node to go into the media.
- 4G.** If the goal is to preserve the genetic material: Place the cutting into a **culture vessel** with **Shoots** media.
- 4H.** If the goal is to create a mother plant: Place the cutting into a **culture vessel** with **Roots** media.
- 4I.** Sterilize the **forceps** and **scalpel** blade with the alcohol burner after each cutting.
- 4J.** Spray the work surface with alcohol after each cutting.  
**Note:** Repeat steps 4E-4J for each explant dissected.
- 4K.** When all **culture vessels** are prepared with newly made explants, store them under a clone light at 75-125 PPFd and 20-25.5°C (68-78°F) room temperature.

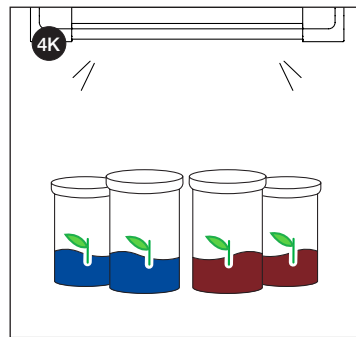
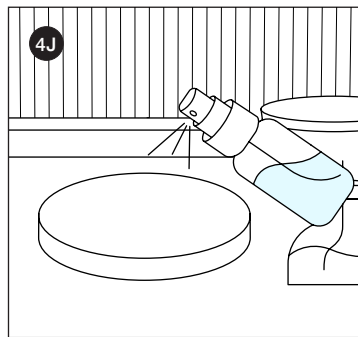
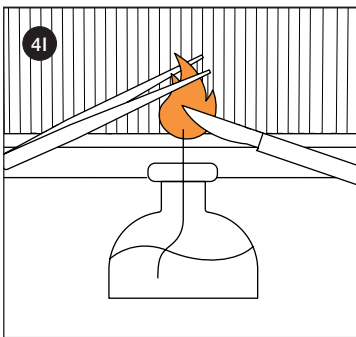
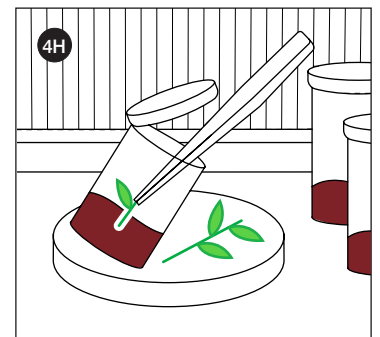
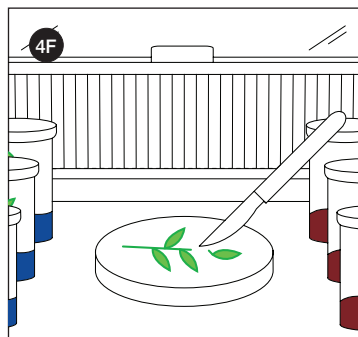
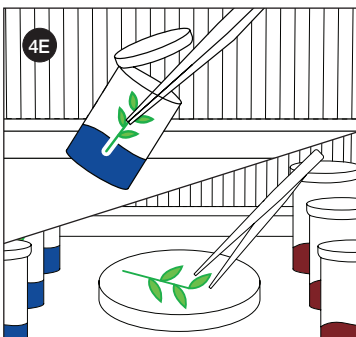
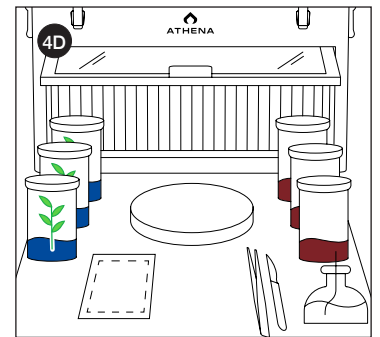
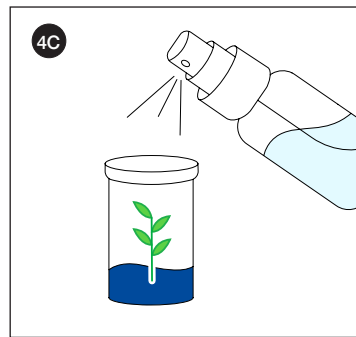
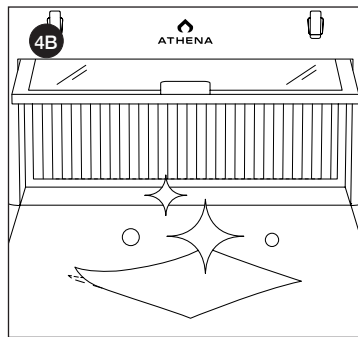
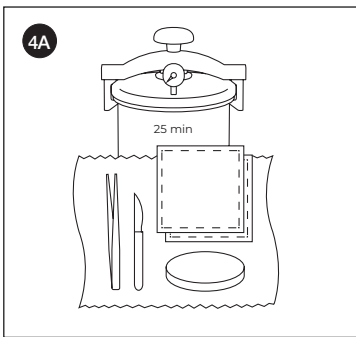

Read the entire Directions for Use, Conditions of Warranties, and Limitations of Liability before using this product. If the terms are not acceptable, return the unopened product container at once. By using this product, user or buyer accepts the following Conditions, Disclaimer of Warranties, and Limitations of Liability.

**CONDITIONS:** The directions for use of this product are believed to be adequate and must be followed carefully. However, it is impossible to eliminate all risks associated with the use of this product. Crop injury, ineffectiveness, or other unintended consequences may result because of such factors such as weather conditions, presence of other materials, or the manner of use or application, all of which are beyond the control of Athena Ag, Inc. All such risks shall be assumed by the user or buyer. **DISCLAIMER OF WARRANTIES:** To the extent consistent with applicable law, Athena Ag, Inc. makes no other warranties, express or implied, of merchantability or of fitness for a particular purpose or otherwise, that extend beyond the statements made on the product's label. No agent of Athena Ag, Inc. is authorized to make any warranties beyond those contained herein or to modify the warranties contained herein. To the extent consistent with applicable law, Athena Ag, Inc. disclaims any liability whatsoever for special, incidental, or consequential damages resulting from the use or handling of this product. **LIMITATIONS OF LIABILITY:** To the extent consistent with applicable law, the exclusive remedy of the user or buyer for any and all losses, injuries, or damages resulting from the use or handling of this product, whether in contract, warranty, tort, negligence, strict liability or otherwise, shall not exceed the purchase price paid, or at Athena Ag Inc.'s election, the replacement of product.

Follow us on Instagram!

@Athena.Ag

A01.002

AthenaAg.com

ATHENA®